



## MINIMOTOR MCF WORM GEAR MOTOR

MCF2T2-10 B3

230/400V 3 ph 280rpm 1 Nm B3 mount

- For clean environments
- IP67 as standard
- Up to 6.4Nm rated torque
- Minimal dirt trap points
- Epoxy coated with no external fan



### PRODUCT DESCRIPTION

#### WORM GEARED MOTOR

White epoxy coating for increased protection against chemicals and harsh working environments.  
IP67 rated with no external fan.

MOTOR: Asynchronous three-phase motor with 2 poles, totally Class H winding in accordance with CEI EN 60034-1.

GEAR UNIT: With die-cast aluminium casing. Wheel rim in special bronze 120/160 HB hardness. Worm gear in hardened steel with thread rotating on ball and roller bearings. Output shaft in stainless steel on request

Lubrication with special long-lasting oil. Sealing rings made in special white rubber for high temperatures.  
Rated torque from 0,8 to 5 Nm. Version B3 or B5. B5/S left version - B5/D right version.

The standard MCE version is also available with IP67 called MCEF

[Please click here for 2D and 3D drawings](#)

### TECHNICAL DATA

Input voltage ac	230Δ/400Y
IP class	IP67
Nominal speed	280 rpm
Nominal torque	1 Nm
Output power	31 W
Rated current	0.30Δ/0.17Y A
Ratio	10:1

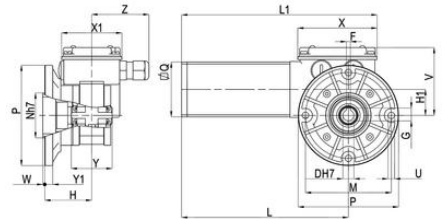
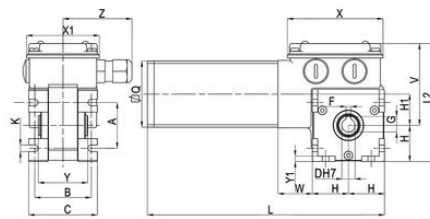
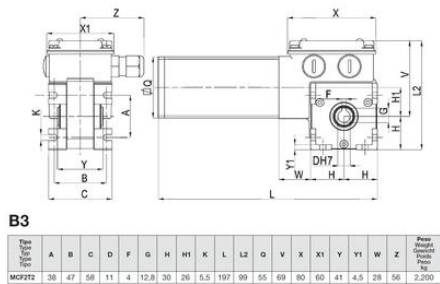

CPU model selection

Electric motors

15.06.2017

Gear motor

15.06.2017

Worm gear motors

15.06.2017

Brushless servomotors

15.06.2017

Clean products

15.06.2017

Please see product description above for 2D and 3D drawings

Others